

ARKIMEDE 115 - PAVING



INDEX

1. Code Registry
2. Description
3. Use
4. Fields of use
5. Load test
6. Technical specification

1. CODE REGISTRY

Code	Description	Dimension (mm)	Weight (kg)	Pkg. / Pallet
TER09-1173/4A2M	ARKIMEDE 115 Paving - 4 wings for 2 mm joint	from 115 to 220	0,358	15 pcs. / 225 pcs.
TER09-1173/4A4M	ARKIMEDE 115 Paving - 4 wings for 4 mm joint	from 115 to 220	0,358	15 pcs. / 225 pcs.

MATERIAL

Made of PP (polypropylene).

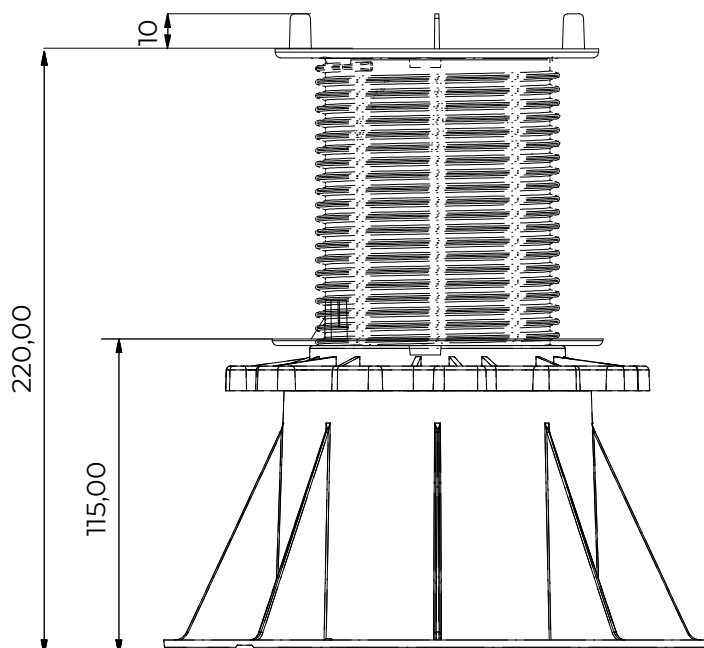

ARKIMEDE 115 - PAVING

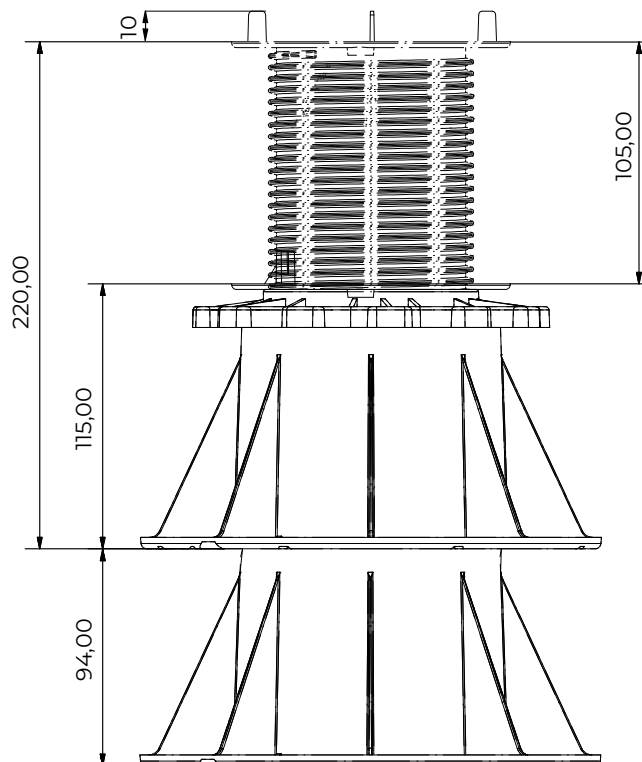

Each base has a special bottom shape that allows to be stack on another base.

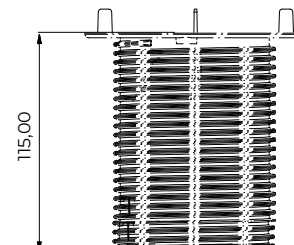
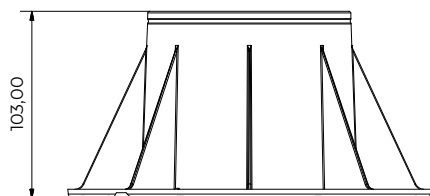
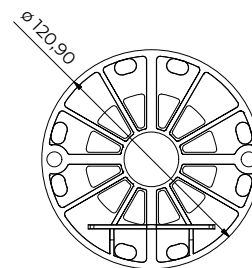
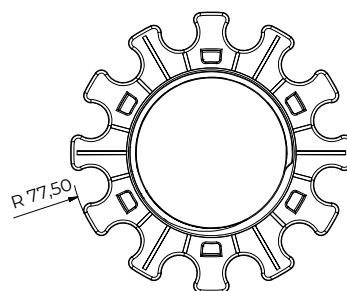
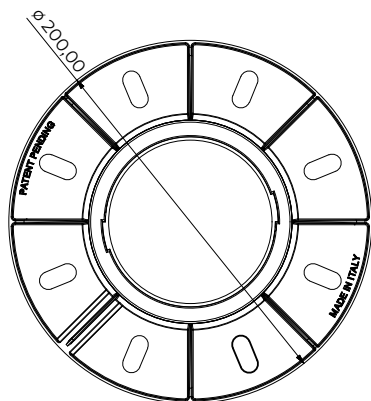

2. DESCRIPTION

ARKIMEDE 115 Paving support with adjustable height starting from 115 to 220 cm (without 100 mm extension).

Base laying surface: 314 cm².

Head diameter: 120 mm with a laying surface of 113 cm².

Available versions:

- Box composed by the base, rotating nut and head with 4 spacer tabs of 2 mm thickness.
- Box composed by the base, rotating nut and head with 4 spacer tabs of 4 mm thickness.

The base allows the correct water drainage.

Extension 100 mm height is suitable for Arkimede 115 Paving

ARKIMEDE 115 - PAVING

3. USE

Used in external areas, terraces, pavements.

Operating temperature: from - 40 ° C to + 80 ° C.

4. FIELDS OF USE

Waterproof membrane, hard insulating panels, screeds and solid and compact pose plans

5. LOAD TEST

TEST 1

Code	Dimensions	Maximum Load [N]
TER09-1173/4Axx	h = 1.120 mm	9.033

A laying punch of 150 mm diameter was used to carry out the test.

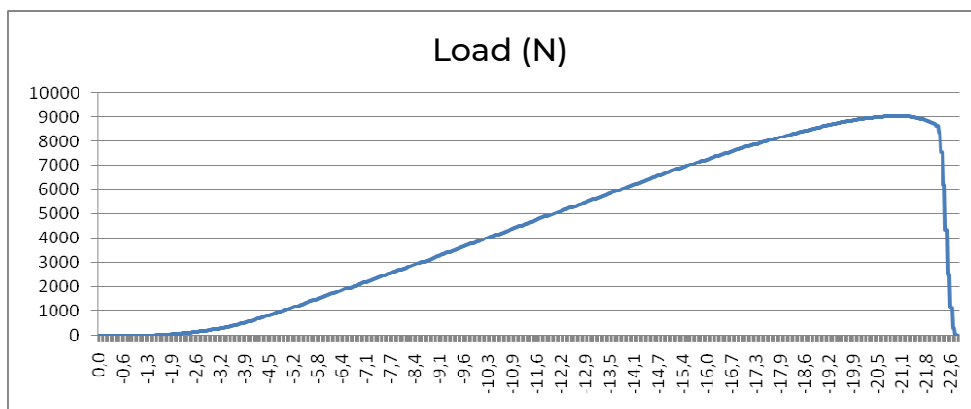

Max. Load	9.033 N
Bend at Max. Load	21,0 mm

TEST 2

Code	Dimensions	Maximum Load [N]
TER09-1173/4Axx	h = 1.100 mm	10.467

A laying punch of 150 mm diameter was used to carry out the test.

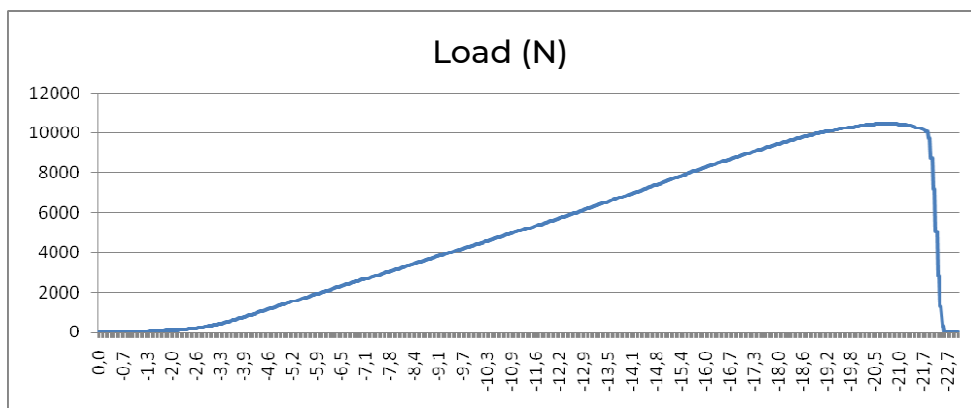

Carico Max	Max. Load	10.467 N
Flessione a Carico Max	Bend at Max. Load	20,7 mm

6. TECHNICAL SPECIFICATION

Specification	Description	Unity	Price
Dak.O.TER09-1173/4AxxM	Supply and installation of ARKIMEDE 115 - Decking support with adjustable height starting from 115 mm. Base laying surface: 314 cm². Head diameter: 120 mm with a laying surface of 113 cm². Available versions: · Box composed by the base, rotating nut and head with 1 tab for joists. The base allows the correct water drainage. Made of PP (polypropylene). Used in external areas, terraces, pavements.		
Dak.O.TER09-1173/4A2M	Arkimede 115 Paving - 4 wings for 2mm joint.....	pc.	-
Dak.O.TER09-1173/4A4M	Arkimede 115 Paving - 4 wings for 4mm joint.....	pc.	-